

HEARITIGE SURVEYING, CO.

TIM. D. HEARITIGE
727 West Point Loop
West Point, Texas 78963

Registered Professional Land Surveyor No. 5036
Licenced State Land Surveyor
Phone (979)242-3485

August 31, 2022

FIELD NOTE DESCRIPTION OF 33.932 ACRES OF LAND OUT OF THE JOHN COOK LEAGUE, ABSTRACT NO. 34, IN FAYETTE COUNTY, TEXAS, AND BEING THAT SAME (33.89 ACRE) TRACT OF LAND CONVEYED TO PHILIP WEIKEL IN A DEED AS DESCRIBED AND RECORDED IN VOLUME 1240 PAGE 247 OF THE OFFICIAL RECORDS OF FAYETTE COUNTY, TEXAS, AND BEING MORE PARTICULARLY DESCRIBED BY METES AND BOUNDS AS FOLLOWS:

BEGINNING at a ½" iron rod found at the base of a fence corner post in the easterly right-of-way line of Prairie Valley Road (County Road No. 108) and being at the most southwesterly corner of that certain (33.89 acre) tract of land conveyed to Philip Weikel in a deed as recorded in Volume 1240 Page 247 of the Official Records of Fayette County, Texas, and being at the most northwesterly corner of that certain (First Tract-11.39 acre) tract of land conveyed to Vastine Havemann in a deed as recorded in Volume 501 Page 170 of the Deed Records of Fayette County, Texas, and being for the most southwesterly corner of the tract herein described, and from which another ½" iron rod found bears **S 02 deg. 31' 56" E 214.84 feet**,

THENCE, with the easterly right-of-way line of Prairie Valley Road, and the westerly line of the Nuckolls tract, **N 00 deg. 15' 38" W 355.35 feet** to a ½" iron rod found at the base of a fence corner post at the most westerly northwest corner of the Weikel tract, also being at the most southwesterly corner of that certain (10.000 acre) tract of land conveyed to Norman Wayne Ermis in a deed as recorded in Volume 1351 Page 189 of the Official Records of Fayette County, Texas, and being for the most westerly northwest corner of this tract, and from which another ½" iron rod found bears **N 00 deg. 43' 35" W 795.52 feet**,

THENCE, leaving the easterly right-of-way line of Prairie Valley Road, and with the common line between the Weikel tract and the Ermis tracts, **N 89 deg. 11' 19" E 1328.08 feet** to a ½" iron rod found at the base of a fence corner post, and **N 00 deg. 38' 29" W 668.10 feet** to a ½" iron rod found at the base of a fence corner post at the most northerly northwest corner of the Weikel tract, and being at the most northeasterly corner of that certain (12.58 acre) tract of land conveyed to Norman Wayne Ermis in a deed as recorded in Volume 1536 Page 323 of the Official Records of Fayette County, Texas, and also being in the southerly line of that certain (45.7 acre) tract of land conveyed to Mona Renee Nuckolls in a deed as recorded in Volume 1856 Page 953 of the Official Records of Fayette County, Texas, and being for the most northerly northwest corner of this tract, and from which another ½" iron rod found bears **N 85 deg. 20' 00" W 1334.95 feet**,

THENCE, with the common line between the Weikel tract, and the Nuckolls tract, **S 85 deg. 47' 42" E 283.53 feet** to a ½" iron rod found at the base of a fence angle post, and **N 89 deg. 25' 34" E 715.28 feet** to a ½" iron rod set at the base of a fence corner post, being for the most northeasterly corner of the Weikel tract, and being at the most northwesterly corner of that certain (37.505 acre) tract of land conveyed to Henry Clifton Giese in a deed as recorded in Volume 519 Page 785 of the Deed Records of Fayette County, Texas, being for the most northeasterly corner of this tract, and from which another ½" iron rod found bears **N 85 deg. 25' 34" E 745.23 feet**,

THENCE, with the common line between the Weikel tract and the Giese tract, **S 00 deg. 42' 29" E 1001.09 feet** to a ½" iron rod found at the base of a fence corner post at the most southeasterly corner of the Weikel tract, and also being at the most northeasterly corner of the Havemann tract, and being for the most southeasterly corner of this tract,

THENCE, with the common line between the Weikel tract and the Havemann tract, **S 89 deg. 19' 19" W 2329.39 feet** to the **PLACE OF BEGINNING**, in all containing **33.932 acres** of land.

SURVEYED: August 29, 2022

BY:

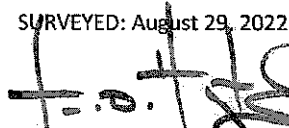

Timothy D. Hearitige

Registered Professional Land Surveyor No. 5036

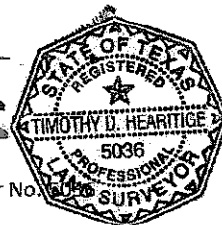

see accompanying map no. C 232032



SELLER'S DISCLOSURE NOTICE

©Texas Association of REALTORS®, Inc. 2022

Section 5.008, Property Code requires a seller of residential property of not more than one dwelling unit to deliver a Seller's Disclosure Notice to a buyer on or before the effective date of a contract. This form complies with and contains additional disclosures which exceed the minimum disclosures required by the Code.

**1250 Prairie Valley Road
La Grange, TX 78945**

CONCERNING THE PROPERTY AT _____

THIS NOTICE IS A DISCLOSURE OF SELLER'S KNOWLEDGE OF THE CONDITION OF THE PROPERTY AS OF THE DATE SIGNED BY SELLER AND IS NOT A SUBSTITUTE FOR ANY INSPECTIONS OR WARRANTIES THE BUYER MAY WISH TO OBTAIN. IT IS NOT A WARRANTY OF ANY KIND BY SELLER, SELLER'S AGENTS, OR ANY OTHER AGENT.

Seller ___ is is not occupying the Property. If unoccupied (by Seller), how long since Seller has occupied the Property? ___ (approximate date) or never occupied the Property

Section 1. The Property has the items marked below: (Mark Yes (Y), No (N), or Unknown (U).)

This notice does not establish the items to be conveyed. The contract will determine which items will & will not convey.

Item	Y	N	U
Cable TV Wiring		<input checked="" type="checkbox"/>	
Carbon Monoxide Det.	<input checked="" type="checkbox"/>		
Ceiling Fans	<input checked="" type="checkbox"/>		
Cooktop	<input checked="" type="checkbox"/>		
Dishwasher	<input checked="" type="checkbox"/>		
Disposal		<input checked="" type="checkbox"/>	
Emergency Escape Ladder(s)		<input checked="" type="checkbox"/>	
Exhaust Fans	<input checked="" type="checkbox"/>		
Fences	<input checked="" type="checkbox"/>		
Fire Detection Equip.	<input checked="" type="checkbox"/>		
French Drain		<input checked="" type="checkbox"/>	
Gas Fixtures		<input checked="" type="checkbox"/>	
Liquid Propane Gas:		<input checked="" type="checkbox"/>	
-LP Community (Captive)		<input checked="" type="checkbox"/>	
-LP on Property		<input checked="" type="checkbox"/>	

Item	Y	N	U
Natural Gas Lines		<input checked="" type="checkbox"/>	
Fuel Gas Piping:		<input checked="" type="checkbox"/>	
-Black Iron Pipe		<input checked="" type="checkbox"/>	
-Copper		<input checked="" type="checkbox"/>	
-Corrugated Stainless Steel Tubing		<input checked="" type="checkbox"/>	
Hot Tub		<input checked="" type="checkbox"/>	
Intercom System		<input checked="" type="checkbox"/>	
Microwave	<input checked="" type="checkbox"/>		
Outdoor Grill		<input checked="" type="checkbox"/>	
Patio/Decking	<input checked="" type="checkbox"/>		
Plumbing System	<input checked="" type="checkbox"/>		
Pool		<input checked="" type="checkbox"/>	
Pool Equipment		<input checked="" type="checkbox"/>	
Pool Maint. Accessories		<input checked="" type="checkbox"/>	
Pool Heater		<input checked="" type="checkbox"/>	

Item	Y	N	U
Pump: sump grinder		<input checked="" type="checkbox"/>	
Rain Gutters		<input checked="" type="checkbox"/>	
Range/Stove	<input checked="" type="checkbox"/>		
Roof/Attic Vents	<input checked="" type="checkbox"/>		
Sauna		<input checked="" type="checkbox"/>	
Smoke Detector	<input checked="" type="checkbox"/>		
Smoke Detector - Hearing Impaired			<input checked="" type="checkbox"/>
Spa		<input checked="" type="checkbox"/>	
Trash Compactor		<input checked="" type="checkbox"/>	
TV Antenna		<input checked="" type="checkbox"/>	
Washer/Dryer Hookup	<input checked="" type="checkbox"/>		
Window Screens	<input checked="" type="checkbox"/>		
Public Sewer System		<input checked="" type="checkbox"/>	

Item	Y	N	U	Additional Information
Central A/C	<input checked="" type="checkbox"/>			<input checked="" type="checkbox"/> electric <input type="checkbox"/> gas number of units: 1
Evaporative Coolers		<input checked="" type="checkbox"/>		number of units: _____
Wall/Window AC Units		<input checked="" type="checkbox"/>		number of units: _____
Attic Fan(s)			<input checked="" type="checkbox"/>	if yes, describe: _____
Central Heat	<input checked="" type="checkbox"/>			<input checked="" type="checkbox"/> electric <input type="checkbox"/> gas number of units: 1
Other Heat		<input checked="" type="checkbox"/>		if yes, describe: _____
Oven	<input checked="" type="checkbox"/>			number of ovens: _____ electric <input type="checkbox"/> gas <input type="checkbox"/> other: _____
Fireplace & Chimney		<input checked="" type="checkbox"/>		wood <input type="checkbox"/> gas logs <input type="checkbox"/> mock <input type="checkbox"/> other: _____
Carport	<input checked="" type="checkbox"/>			attached <input checked="" type="checkbox"/> not attached
Garage		<input checked="" type="checkbox"/>		attached <input type="checkbox"/> not attached
Garage Door Openers		<input checked="" type="checkbox"/>		number of units: _____ number of remotes: _____
Satellite Dish & Controls		<input checked="" type="checkbox"/>		owned <input type="checkbox"/> leased from: _____
Security System		<input checked="" type="checkbox"/>		owned <input type="checkbox"/> leased from: _____

(TXR-1406) 07-10-23

Initialed by: Buyer: _____, _____ and Seller: *PL*, _____

Page 1 of 7

**1250 Prairie Valley Road
La Grange, TX 78945**

Concerning the Property at _____

Solar Panels		<input checked="" type="checkbox"/>	owned	leased from:
Water Heater	<input checked="" type="checkbox"/>		<input checked="" type="checkbox"/> electric	gas other: _____ number of units: _____
Water Softener		<input checked="" type="checkbox"/>	owned	leased from:
Other Leased Items(s)		<input checked="" type="checkbox"/>	if yes, describe:	
Underground Lawn Sprinkler		<input checked="" type="checkbox"/>	___ automatic ___ manual areas covered _____	
Septic / On-Site Sewer Facility	<input checked="" type="checkbox"/>		if yes, attach Information About On-Site Sewer Facility (TXR-1407)	

Water supply provided by: ___ city well ___ MUD ___ co-op ___ unknown ___ other: _____

Was the Property built before 1978? ___ yes no ___ unknown

(If yes, complete, sign, and attach TXR-1906 concerning lead-based paint hazards).

Roof Type: Metal Age: 9-years (approximate)

Is there an overlay roof covering on the Property (shingles or roof covering placed over existing shingles or roof covering)? ___ yes no ___ unknown

Are you (Seller) aware of any of the items listed in this Section 1 that are not in working condition, that have defects, or are need of repair? ___ yes no If yes, describe (attach additional sheets if necessary): _____

Section 2. Are you (Seller) aware of any defects or malfunctions in any of the following? (Mark Yes (Y) if you are aware and No (N) if you are not aware.)

Item	Y	N
Basement		<input checked="" type="checkbox"/>
Ceilings		<input checked="" type="checkbox"/>
Doors		<input checked="" type="checkbox"/>
Driveways		<input checked="" type="checkbox"/>
Electrical Systems		<input checked="" type="checkbox"/>
Exterior Walls		<input checked="" type="checkbox"/>

Item	Y	N
Floors		<input checked="" type="checkbox"/>
Foundation / Slab(s)		<input checked="" type="checkbox"/>
Interior Walls	<input checked="" type="checkbox"/>	
Lighting Fixtures		<input checked="" type="checkbox"/>
Plumbing Systems		<input checked="" type="checkbox"/>
Roof		<input checked="" type="checkbox"/>

Item	Y	N
Sidewalks		<input checked="" type="checkbox"/>
Walls / Fences		<input checked="" type="checkbox"/>
Windows		<input checked="" type="checkbox"/>
Other Structural Components		<input checked="" type="checkbox"/>

If the answer to any of the items in Section 2 is yes, explain (attach additional sheets if necessary): Wall panel paper torn and panel strip damaged in hall to master bedroom

Section 3. Are you (Seller) aware of any of the following conditions? (Mark Yes (Y) if you are aware and No (N) if you are not aware.)

Condition	Y	N
Aluminum Wiring		<input checked="" type="checkbox"/>
Asbestos Components		<input checked="" type="checkbox"/>
Diseased Trees: <u>oak wilt</u>		<input checked="" type="checkbox"/>
Endangered Species/Habitat on Property		<input checked="" type="checkbox"/>
Fault Lines		<input checked="" type="checkbox"/>
Hazardous or Toxic Waste		<input checked="" type="checkbox"/>
Improper Drainage		<input checked="" type="checkbox"/>
Intermittent or Weather Springs		<input checked="" type="checkbox"/>
Landfill		<input checked="" type="checkbox"/>
Lead-Based Paint or Lead-Based Pt. Hazards		<input checked="" type="checkbox"/>
Encroachments onto the Property		<input checked="" type="checkbox"/>
Improvements encroaching on others' property		<input checked="" type="checkbox"/>
Located in Historic District		<input checked="" type="checkbox"/>
Historic Property Designation		<input checked="" type="checkbox"/>
Previous Foundation Repairs		<input checked="" type="checkbox"/>

Condition	Y	N
Radon Gas		<input checked="" type="checkbox"/>
Settling		<input checked="" type="checkbox"/>
Soil Movement		<input checked="" type="checkbox"/>
Subsurface Structure or Pits		<input checked="" type="checkbox"/>
Underground Storage Tanks		<input checked="" type="checkbox"/>
Unplatted Easements		<input checked="" type="checkbox"/>
Unrecorded Easements		<input checked="" type="checkbox"/>
Urea-formaldehyde Insulation		<input checked="" type="checkbox"/>
Water Damage Not Due to a Flood Event		<input checked="" type="checkbox"/>
Wetlands on Property		<input checked="" type="checkbox"/>
Wood Rot		<input checked="" type="checkbox"/>
Active infestation of termites or other wood destroying insects (WDI)		<input checked="" type="checkbox"/>
Previous treatment for termites or WDI		<input checked="" type="checkbox"/>
Previous termite or WDI damage repaired		<input checked="" type="checkbox"/>
Previous Fires ^{DS}		<input checked="" type="checkbox"/>

(TXR-1406) 07-10-23

Initialed by: Buyer: _____ and Seller: PEW

1250 Prairie Valley Road
La Grange, TX 78945

Concerning the Property at _____

Previous Roof Repairs	<input checked="" type="checkbox"/>	
Previous Other Structural Repairs		<input checked="" type="checkbox"/>
Previous Use of Premises for Manufacture of Methamphetamine		<input checked="" type="checkbox"/>

Termite or WDI damage needing repair		<input checked="" type="checkbox"/>
Single Blockable Main Drain in Pool/Hot Tub/Spa*		<input checked="" type="checkbox"/>

If the answer to any of the items in Section 3 is yes, explain (attach additional sheets if necessary):
Roof was replaced after storm damage

*A single blockable main drain may cause a suction entrapment hazard for an individual.

Section 4. Are you (Seller) aware of any item, equipment, or system in or on the Property that is in need of repair, which has not been previously disclosed in this notice? yes no If yes, explain (attach additional sheets if necessary):
Original well is not functioning and has been abandoned in lue of new well.

Section 5. Are you (Seller) aware of any of the following conditions?* (Mark Yes (Y) if you are aware and check wholly or partly as applicable. Mark No (N) if you are not aware.)

- Y N
- Present flood insurance coverage.
 - Previous flooding due to a failure or breach of a reservoir or a controlled or emergency release of water from a reservoir.
 - Previous flooding due to a natural flood event.
 - Previous water penetration into a structure on the Property due to a natural flood.
 - Located wholly partly in a 100-year floodplain (Special Flood Hazard Area-Zone A, V, A99, AE, AO, AH, VE, or AR).
 - Located wholly partly in a 500-year floodplain (Moderate Flood Hazard Area-Zone X (shaded)).
 - Located wholly partly in a floodway.
 - Located wholly partly in a flood pool.
 - Located wholly partly in a reservoir.

If the answer to any of the above is yes, explain (attach additional sheets as necessary): Far back portion of property in 100-year floodplain as shown on surey

***If Buyer is concerned about these matters, Buyer may consult Information About Flood Hazards (TXR 1414).**

For purposes of this notice:

"100-year floodplain" means any area of land that: (A) is identified on the flood insurance rate map as a special flood hazard area, which is designated as Zone A, V, A99, AE, AO, AH, VE, or AR on the map; (B) has a one percent annual chance of flooding, which is considered to be a high risk of flooding; and (C) may include a regulatory floodway, flood pool, or reservoir.

"500-year floodplain" means any area of land that: (A) is identified on the flood insurance rate map as a moderate flood hazard area, which is designated on the map as Zone X (shaded); and (B) has a two-tenths of one percent annual chance of flooding, which is considered to be a moderate risk of flooding.

"Flood pool" means the area adjacent to a reservoir that lies above the normal maximum operating level of the reservoir and that is subject to controlled inundation under the management of the United States Army Corps of Engineers.

(TXR-1406) 07-10-23

Initialed by: Buyer: _____, _____ and Seller: JL, _____

Page 3 of 7

1250 Prairie Valley Road
La Grange, TX 78945

Concerning the Property at _____

"Flood insurance rate map" means the most recent flood hazard map published by the Federal Emergency Management Agency under the National Flood Insurance Act of 1968 (42 U.S.C. Section 4001 et seq.).

"Floodway" means an area that is identified on the flood insurance rate map as a regulatory floodway, which includes the channel of a river or other watercourse and the adjacent land areas that must be reserved for the discharge of a base flood, also referred to as a 100-year flood, without cumulatively increasing the water surface elevation more than a designated height.

"Reservoir" means a water impoundment project operated by the United States Army Corps of Engineers that is intended to retain water or delay the runoff of water in a designated surface area of land.

Section 6. Have you (Seller) ever filed a claim for flood damage to the Property with any insurance provider, including the National Flood Insurance Program (NFIP)?* yes no If yes, explain (attach additional sheets as necessary): _____

*Homes in high risk flood zones with mortgages from federally regulated or insured lenders are required to have flood insurance. Even when not required, the Federal Emergency Management Agency (FEMA) encourages homeowners in high risk, moderate risk, and low risk flood zones to purchase flood insurance that covers the structure(s) and the personal property within the structure(s).

Section 7. Have you (Seller) ever received assistance from FEMA or the U.S. Small Business Administration (SBA) for flood damage to the Property? yes no If yes, explain (attach additional sheets as necessary): _____

Section 8. Are you (Seller) aware of any of the following? (Mark Yes (Y) if you are aware. Mark No (N) if you are not aware.)

Y N

- Room additions, structural modifications, or other alterations or repairs made without necessary permits, with unresolved permits, or not in compliance with building codes in effect at the time.
- Homeowners' associations or maintenance fees or assessments. If yes, complete the following:
 Name of association: _____
 Manager's name: _____ Phone: _____
 Fees or assessments are: \$ _____ per _____ and are: mandatory voluntary
 Any unpaid fees or assessment for the Property? yes (\$ _____) no
 If the Property is in more than one association, provide information about the other associations below or attach information to this notice.
- Any common area (facilities such as pools, tennis courts, walkways, or other) co-owned in undivided interest with others. If yes, complete the following:
 Any optional user fees for common facilities charged? yes no If yes, describe: _____
- Any notices of violations of deed restrictions or governmental ordinances affecting the condition or use of the Property.
- Any lawsuits or other legal proceedings directly or indirectly affecting the Property. (Includes, but is not limited to: divorce, foreclosure, heirship, bankruptcy, and taxes.)
- Any death on the Property except for those deaths caused by: natural causes, suicide, or accident unrelated to the condition of the Property.
- Any condition on the Property which materially affects the health or safety of an individual.
- Any repairs or treatments, other than routine maintenance, made to the Property to remediate environmental hazards such as asbestos, radon, lead-based paint, urea-formaldehyde, or mold.
 If yes, attach any certificates or other documentation identifying the extent of the remediation (for example, certificate of mold remediation or other remediation).
- Any rainwater harvesting system located on the Property that is larger than 500 gallons and that uses a public water supply as an auxiliary water source.

(TXR-1406) 07-10-23

Initialed by: Buyer: _____, _____ and Seller: *MW*, _____

Page 4 of 7

1250 Prairie Valley Road
La Grange, TX 78945

Concerning the Property at _____

Seller acknowledges that the statements in this notice are true to the best of Seller's belief and that no person, including the broker(s), has instructed or influenced Seller to provide inaccurate information or to omit any material information.

3/5/2024

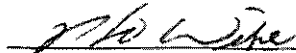
	_____	Date	Signature of Seller	_____	Date
Printed Name: <u>Philip Weikel</u>	_____		Printed Name: _____	_____	

ADDITIONAL NOTICES TO BUYER:

- (1) The Texas Department of Public Safety maintains a database that the public may search, at no cost, to determine if registered sex offenders are located in certain zip code areas. To search the database, visit <https://publicsite.dps.texas.gov>. For information concerning past criminal activity in certain areas or neighborhoods, contact the local police department.
- (2) If the Property is located in a coastal area that is seaward of the Gulf Intracoastal Waterway or within 1,000 feet of the mean high tide bordering the Gulf of Mexico, the Property may be subject to the Open Beaches Act or the Dune Protection Act (Chapter 61 or 63, Natural Resources Code, respectively) and a beachfront construction certificate or dune protection permit may be required for repairs or improvements. Contact the local government with ordinance authority over construction adjacent to public beaches for more information.
- (3) If the Property is located in a seacoast territory of this state designated as a catastrophe area by the Commissioner of the Texas Department of Insurance, the Property may be subject to additional requirements to obtain or continue windstorm and hail insurance. A certificate of compliance may be required for repairs or improvements to the Property. For more information, please review *Information Regarding Windstorm and Hail Insurance for Certain Properties* (TXR 2518) and contact the Texas Department of Insurance or the Texas Windstorm Insurance Association.
- (4) This Property may be located near a military installation and may be affected by high noise or air installation compatible use zones or other operations. Information relating to high noise and compatible use zones is available in the most recent Air Installation Compatible Use Zone Study or Joint Land Use Study prepared for a military installation and may be accessed on the Internet website of the military installation and of the county and any municipality in which the military installation is located.
- (5) If you are basing your offers on square footage, measurements, or boundaries, you should have those items independently measured to verify any reported information.
- (6) The following providers currently provide service to the Property:

Electric: <u>FEC</u>	_____	phone #: <u>979-968-3181</u>	_____
Sewer: _____	_____	phone #: _____	_____
Water: _____	_____	phone #: _____	_____
Cable: _____	_____	phone #: _____	_____
Trash: _____	_____	phone #: _____	_____
Natural Gas: _____	_____	phone #: _____	_____
Phone Company: _____	_____	phone #: _____	_____
Propane: _____	_____	phone #: _____	_____
Internet: _____	_____	phone #: _____	_____

**1250 Prairie Valley Road
La Grange, TX 78945**

Concerning the Property at _____

(7) This Seller's Disclosure Notice was completed by Seller as of the date signed. The brokers have relied on this notice as true and correct and have no reason to believe it to be false or inaccurate. YOU ARE ENCOURAGED TO HAVE AN INSPECTOR OF YOUR CHOICE INSPECT THE PROPERTY.

The undersigned Buyer acknowledges receipt of the foregoing notice.

Signature of Buyer	Date	Signature of Buyer	Date
Printed Name: _____	_____	Printed Name: _____	_____

(TXR-1406) 07-10-23

Initialed by: Buyer: _____, _____ and Seller: ^{DS} PGW, _____

Page 7 of 7



PROMULGATED BY THE TEXAS REAL ESTATE COMMISSION (TREC)

11-08-2021



ADDENDUM CONTAINING NOTICE OF OBLIGATION TO PAY IMPROVEMENT DISTRICT ASSESSMENT TO Fayette County, TEXAS

**CONCERNING THE FOLLOWING PROPERTY
1250 Prairie Valley Road, La Grange, TX 78945**

As the purchaser of the real property described above, you are obligated to pay assessments to Fayette County, Texas, for the costs of a portion of a public improvement or services project (the "Authorized Improvements") undertaken for the benefit of the property within Fayette County Groundwater Conservation District (the "District") created under Local Government Code

AN ASSESSMENT HAS BEEN LEVIED AGAINST YOUR PROPERTY FOR THE AUTHORIZED IMPROVEMENTS, WHICH MAY BE PAID IN FULL AT ANY TIME. IF THE ASSESSMENT IS NOT PAID IN FULL, IT WILL BE DUE AND PAYABLE IN ANNUAL INSTALLMENTS THAT WILL VARY FROM YEAR TO YEAR DEPENDING ON THE AMOUNT OF INTEREST PAID, COLLECTION COSTS, ADMINISTRATIVE COSTS, AND DELINQUENCY COSTS.

The exact amount of the assessment may be obtained from Fayette County. The exact amount of each annual installment will be approved each year by Fayette County Commissioner's Court in the annual service plan update for the district. More information about the assessments, including the amounts and due dates, may be obtained from Fayette County

Your failure to pay any assessment or any annual installment may result in penalties and interest being added to what you owe or in a lien on and the foreclosure of your property.

DocuSigned by: PHILIP WEIKEL 3/2/2024
Signature of Seller Date Signature of Seller Date
Philip Weikel

The undersigned purchaser acknowledges receipt of this notice before the effective date of a binding contract for the purchase of the real property at the address described above.

Signature of Buyer Date Signature of Buyer Date

TREC logo and disclaimer text: This form has been approved by the Texas Real Estate Commission for use with similarly approved or promulgated contract forms. Such approval relates to this form only. TREC forms are intended for use only by trained real estate license holders. No representation is made as to the legal validity or adequacy of any provision in any specific transactions. It is not suitable for complex transactions. Texas Real Estate Commission, P.O. Box 12188, Austin, TX 78711-2188, (512) 936-3000 (http://www.trec.texas.gov) TREC No. 53-0.

TREC No. 53-0



INFORMATION ABOUT ON-SITE SEWER FACILITY

USE OF THIS FORM BY PERSONS WHO ARE NOT MEMBERS OF THE TEXAS ASSOCIATION OF REALTORS®, INC IS NOT AUTHORIZED
©Texas Association of REALTORS®, Inc., 2004

CONCERNING THE PROPERTY AT 1250 Prairie Valley Road
La Grange, TX 78945

A. DESCRIPTION OF ON-SITE SEWER FACILITY ON PROPERTY:

- (1) Type of Treatment System: Septic Tank Aerobic Treatment Unknown
- (2) Type of Distribution System: _____ Unknown
- (3) Approximate Location of Drain Field or Distribution System: 125 ft E-SE of home Unknown
- (4) Installer: Hunter Environmental Services Unknown
- (5) Approximate Age: 18 months Unknown

B. MAINTENANCE INFORMATION:

- (1) Is Seller aware of any maintenance contract in effect for the on-site sewer facility? Yes No
If yes, name of maintenance contractor: _____
Phone: _____ contract expiration date: _____
Maintenance contracts must be in effect to operate aerobic treatment and certain non-standard" on-site sewer facilities.)
- (2) Approximate date any tanks were last pumped? never - barely used (6-months)
- (3) Is Seller aware of any defect or malfunction in the on-site sewer facility? Yes No
If yes, explain: _____
- (4) Does Seller have manufacturer or warranty information available for review? Yes No

C. PLANNING MATERIALS, PERMITS, AND CONTRACTS:

- (1) The following items concerning the on-site sewer facility are attached:
 planning materials permit for original installation final inspection when OSSF was installed
 maintenance contract manufacturer information warranty information _____
- (2) "Planning materials" are the supporting materials that describe the on-site sewer facility that are submitted to the permitting authority in order to obtain a permit to install the on-site sewer facility.
- (3) It may be necessary for a buyer to have the permit to operate an on-site sewer facility transferred to the buyer.

(TXR-1407) 1-7-04

Initialed for Identification by Buyer _____ and Seller gh

Page 1 of 2

1250 Prairie Valley Road
 La Grange, TX 78945

Information about On-Site Sewer Facility concerning _____

D. INFORMATION FROM GOVERNMENTAL AGENCIES: Pamphlets describing on-site sewer facilities are available from the Texas Agricultural Extension Service. Information in the following table was obtained from Texas Commission on Environmental Quality (TCEQ) on 10/24/2002. The table estimates daily wastewater usage rates. Actual water usage data or other methods for calculating may be used if accurate and acceptable to TCEQ.

<u>Facility</u>	<u>Usage (gal/day) without water- saving devices</u>	<u>Usage (gal/day) with water- saving devices</u>
Single family dwelling (1-2 bedrooms; less than 1,500 sf)	225	180
Single family dwelling (3 bedrooms; less than 2,500 sf)	300	240
Single family dwelling (4 bedrooms; less than 3,500 sf)	375	300
Single family dwelling (5 bedrooms; less than 4,500 sf)	450	360
Single family dwelling (6 bedrooms; less than 5,500 sf)	525	420
Mobile home, condo, or townhouse (1-2 bedroom)	225	180
Mobile home, condo, or townhouse (each add'l bedroom)	75	60

This document is not a substitute for any inspections or warranties. This document was completed to the best of Seller's knowledge and belief on the date signed. Seller and real estate agents are not experts about on-site sewer facilities. Buyer is encouraged to have the on-site sewer facility inspected by an inspector of Buyer's choice.

 Signature of Seller
Philip Weikel

3/5/2024

Date

Signature of Seller

Date

Receipt acknowledged by:

 Signature of Buyer

Date

 Signature of Buyer

Date



INFORMATION ABOUT SPECIAL FLOOD HAZARD AREAS

USE OF THIS FORM BY PERSONS WHO ARE NOT MEMBERS OF THE TEXAS ASSOCIATION OF REALTORS®, INC. IS NOT AUTHORIZED.
©Texas Association of REALTORS®, Inc., 2021

CONCERNING THE PROPERTY AT

1250 Prairie Valley Road
La Grange, TX 78945

A. FLOOD AREAS:

- (1) The Federal Emergency Management Agency (FEMA) designates areas that have a high risk of flooding as special flood hazard areas.
- (2) A property that is in a special flood hazard area is designated on flood insurance rate maps with a zone beginning in a "V" or "A". Both V-Zone and A-Zone areas indicate a high risk of flooding.
- (3) Some properties may also lie in the "floodway" which is the channel of a river or other watercourse and the adjacent land areas that must be reserved in order to discharge a flood under FEMA rules. Communities must regulate development in these floodways.

B. AVAILABILITY OF FLOOD INSURANCE:

- (1) Generally, flood insurance is available regardless of whether the property is located in or out of a special flood hazard area. Contact your insurance agent to determine if any limitations or restrictions apply to the property in which you are interested.
- (2) FEMA encourages every property owner to purchase flood insurance regardless of whether the property is in a high, moderate, or low risk flood area.
- (3) A homeowner may obtain flood insurance coverage (up to certain limits) through the National Flood Insurance Program. Supplemental coverage is available through private insurance carriers.
- (4) A mortgage lender making a federally related mortgage will require the borrower to maintain flood insurance if the property is in a special flood hazard area.

C. GROUND FLOOR REQUIREMENTS:

- (1) Many homes in special flood hazard areas are built-up or are elevated. In elevated homes the ground floor typically lies below the base flood elevation and the first floor is elevated on piers, columns, posts, or piles. The base flood elevation is the highest level at which a flood is likely to occur as shown on flood insurance rate maps.
- (2) Federal, state, county, and city regulations:
 - (a) restrict the use and construction of any ground floor enclosures in elevated homes that are in special flood hazard areas.
 - (b) may prohibit or restrict the remodeling, rebuilding, and redevelopment of property and improvements in the floodway.
- (3) The first floor of all homes must now be built above the base flood elevation.
 - (a) Older homes may have been built in compliance with applicable regulations at the time of construction and may have first floors that lie below the base flood elevation, but flood insurance rates for such homes may be significant.

(TXR 1414) 10-19-2021

DS
PGW

Page 1 of 3

**1250 Prairie Valley Road
La Grange, TX 78945**

Information about Special Flood Hazard Areas concerning _____

- (b) It is possible that modifications were made to a ground floor enclosure after a home was first built. The modifications may or may not comply with applicable regulations and may or may not affect flood insurance rates.
- (c) It is important for a buyer to determine if the first floor of a home is elevated at or above the base flood elevation. It is also important for a buyer to determine if the property lies in a floodway.
- (4) Ground floor enclosures that lie below the base flood elevation may be used only for: (i) parking; (ii) storage; and (iii) building access. Plumbing, mechanical, or electrical items in ground floor enclosures that lie below the base flood elevation may be prohibited or restricted and may not be eligible for flood insurance coverage. Additionally:
 - (a) in A-Zones, the ground floor enclosures below the base flood elevation must have flow-through vents or openings that permit the automatic entry and exit of floodwaters:
 - (b) in V-Zones, the ground floor enclosures must have break-away walls, screening, or lattice walls; and
 - (c) in floodways, the remodeling or reconstruction of any improvements may be prohibited or otherwise restricted.

D. COMPLIANCE:

- (1) The above-referenced property may or may not comply with regulations affecting ground floor enclosures below the base flood elevation.
- (2) A property owner's eligibility to purchase or maintain flood insurance, as well as the cost of the flood insurance, is dependent on whether the property complies with the regulations affecting ground floor enclosures.
- (3) A purchaser or property owner may be required to remove or modify a ground floor enclosure that is not in compliance with city or county building requirements or is not entitled to an exemption from such requirements.
- (4) A flood insurance policy maintained by the current property owner does not mean that the property is in compliance with the regulations affecting ground floor enclosures or that the buyer will be able to continue to maintain flood insurance at the same rate.
- (5) Insurance carriers calculate the cost of flood insurance using a rate that is based on the elevation of the lowest floor.
 - (a) If the ground floor lies below the base flood elevation and does not meet federal, state, county, and city requirements, the ground floor will be the lowest floor for the purpose of computing the rate.
 - (b) If the property is in compliance, the first elevated floor will be the lowest floor and the insurance rate will be significantly less than the rate for a property that is not in compliance.
 - (c) If the property lies in a V-Zone the flood insurance rate will be impacted if a ground floor enclosure below the base flood elevation exceeds 299 square feet (even if constructed with break-away walls).

(TXR 1414) 10-19-2021

Page 2 of 3

DS
PCW

**1250 Prairie Valley Road
La Grange, TX 78945**

Information about Special Flood Hazard Areas concerning _____

E. ELEVATION CERTIFICATE:

The elevation certificate is an important tool in determining flood insurance rates. It is used to provide elevation information that is necessary to ensure compliance with floodplain management laws. To determine the proper insurance premium rate, insurers rely on an elevation certificate to certify building elevations at an acceptable level above flood map levels. If available in your area, it is recommended that you obtain an elevation certificate for the property as soon as possible to accurately determine future flood insurance rates.

You are encouraged to: (1) inspect the property for all purposes, including compliance with any ground floor enclosure requirement; (2) review the flood insurance policy (costs and coverage) with your insurance agent; and (3) contact the building permitting authority if you have any questions about building requirements or compliance issues.

Receipt acknowledged by:

DocuSigned by: PHILIP WEIKEL <small>8CA4F664B65447F...</small>	3/2/2024		
Signature	Date	Signature	Date